

Optimator I

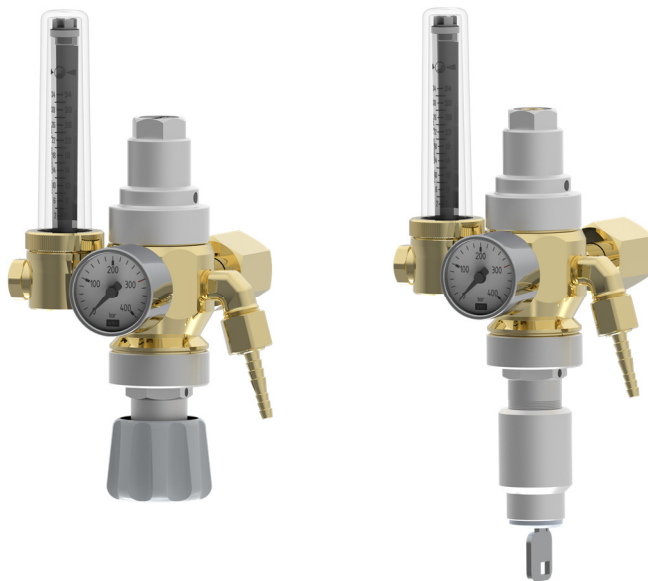

Product features

The Optimator from GasIQ offers enhanced efficiency, quality and sustainability for welding applications with long-term profitability and environmental consideration.

- **Two-stage system:** The Optimator from GasIQ is the original two-stage system ensuring precise control of gas flow for welding applications.
- **Efficient gas usage:** The Optimator's second stage effectively reduces the gas surge during the initial welding moment, resulting in gas savings up to 54%.
- **Improved welding quality:** Reduced gas surge leads to improved welding quality by minimizing porosity in the welds.
- **Quick return in investment:** Estimated ROI in 6 months, making investment economically advantageous.
- **Environmentally friendly:** Environmentally friendly by reducing gas transportation, contributing to sustainable development.
- **Lockable option** Also available as a lockable option with a robust lock for extra security and protection .

Technical data

Type	2-stage / cylinder
Regulator class	0
Standard	ISO 2503
First stage calibrated at	5 bar
Gas	Ar/mix / Ar/H ₂ / CO ₂ / HE
Temperature range	-20°C up to +60°C

Pressure / Flow

Inlet pressure P ₁	200 / 300 bar
Outlet pressure	Depending on flow ,02-1 bar
Q _n	0-5L / 0-20L / 0-34L/min

Materials:

Valve body	CW 614N
Valve seat	Kel-F
Diaphragm	NBR
Valve cap	Aluminum EN 6026
Hand wheel	ZINK, ZP0410
Flow tube	Grilamid TR90°

Connections:

Inlet	See page 2
Outlet	See page 2

Dimensions

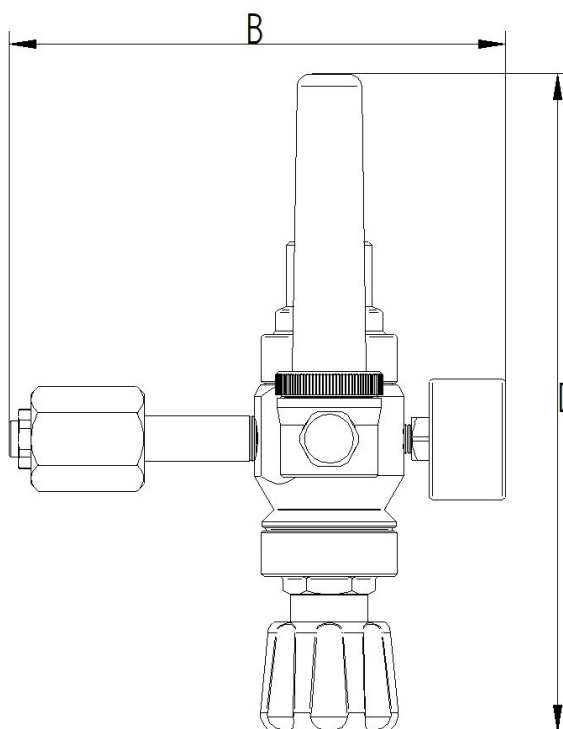
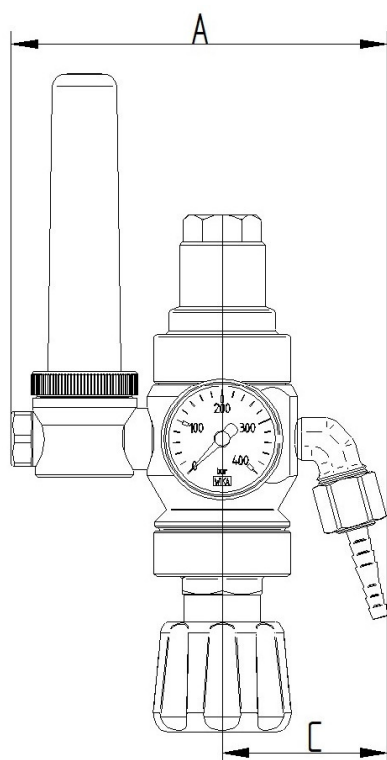

Handwheel					
Inlet	Outlet	A	B	C	D
W21/8" F	G3/8"	123mm	162mm	54mm	213mm
W21/8" F	G1/4"	123mm	162mm	54mm	213mm
W21/8" F	M12x1	126mm	162mm	57mm	213mm
W24/32" F	G3/8"	123mm	162mm	54mm	213mm
Nevoc	G3/8"	123mm	153mm	54mm	213mm
Nevoc	G1/4"	123mm	153mm	54mm	213mm
G1/2" F	G1/4"	123mm	162mm	54mm	213mm
G3/4" F	G3/8"	123mm	162mm	54mm	213mm
G5/8" Bull M	5/8"-18 UNF	126mm	181mm	57mm	213mm
G5/8" Bull M	G3/8"	123mm	181mm	54mm	213mm
W24/52"M	G3/8"	123mm	181mm	54mm	213mm

Lockable					
Inlet	Outlet	A	B	C	D
W21/8" F	G1/4"	123mm	162mm	54mm	240mm
W21/8" F	G3/8"	123mm	162mm	54mm	240mm
W21/8" F	M12x1	126mm	162mm	57mm	240mm
W24/32" F	G3/8"	123mm	162mm	54mm	240mm
W24/52" F	5/8"-18	125mm	181mm	56mm	240mm
CO2 21/8" F	G3/8"	123mm	162mm	54mm	240mm
Nevoc	G3/8"	123mm	171mm	54mm	240mm